

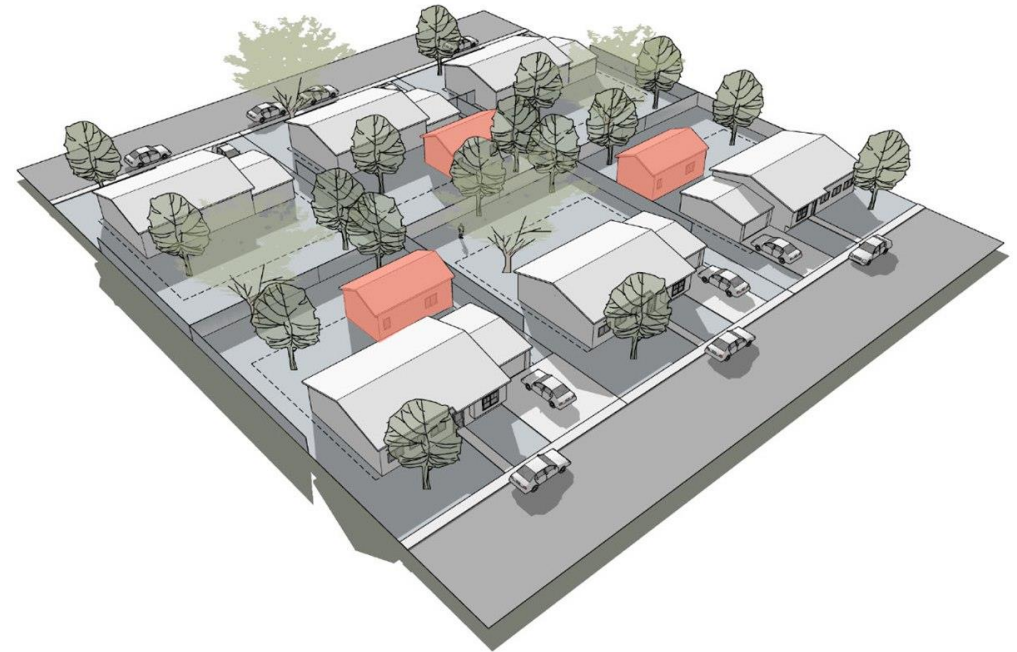

<https://LochlevenWA.org>

# Lochleven Community Association

December 21, 2021





<https://LochlevenWA.org>

# Agenda

- Update
  - Re-Zone Application
  - Street Lighting
  - Restricted Parking Zone (RPZ) update
- DADU – Calibration with existing LUC and Supporting Points



<https://LochlevenWA.org>

# Chimney Condo Rezone

<https://www.lochlevenwa.org/chimney-rezone>

- Dec 16 – Call with Jeremy Barksdale discussing rezone application
- Dec 16 – Advised City the applicant’s contractor for the demolition permit has had their license suspended.
- Dec 14 - Property closed, new buyer paid \$15,250,000, (up from \$11.3 million in 2017).
- Dec 10 – LCA sends letter to Wymond Investments regarding safety and maintenance.
- Dec 10 – LCA sends letter to city regarding rezone’s applicants legal standing requesting the application be nullified.
- Dec 8 - LCA submits oral comments to Planning Commission regarding impact of rezone to the draft NW Neighborhood Comprehensive Plan.





<https://LochlevenWA.org>

# Street Lighting - Update

- 2 new lights approved for 99<sup>th</sup> Ave NE, contract signed with PSE. Will require some tree pruning first.
- Easy Process
  - Anyone can request a new street light on a public street.
  - If the light can be installed on an existing pole, there is typically no cost.
  - Requires the approval of all residents within 100 feet
  - New street light will be filled with LED street lights wherever possible.
  - <https://bellevuewa.gov/city-government/departments/transportation/safety-and-maintenance/traffic-and-street-lighting-operations/street-lights>



<https://LochlevenWA.org>

# Restricted Parking Zone (RPZ)

<https://rpz.bellevuewa.gov/RpzRules>

- Unintended use by residents
- Increased abuse by non-residents & “long-term storage”.
- Recommendations to City
  - Enforce rules for Visitor permits, (not intended for residents).
  - Vehicles with RPZ permits (decal or guest permits) cannot be parked for over x days or up to 1 week.
  - RPZ permits and special rules shall not apply or be granted to “Collector Vehicles”.
  - Vehicles have current registrations must be road worthy defined by DMV.





<https://LochlevenWA.org>





# DADU NW Bellevue Comprehensive Plan

<https://www.lochlevenwa.org/submissions>

- Dec 13 – City Council Meeting
  - DADU policy removed from comprehensive plan and approved by City Council
  - LCA made oral comments supported the revised draft plan, removing mention of DADU and praising the additional emphasis on neighborhood safety
  - Councilman Jeremy Barksdale asked for a vote to request the planning department to expedite resources to review steps to implement DADU.
- Dec 16 – Call with JB discussing DADU (and rezone application)
  - He suggested that rather than list requirements that LCA attempt to articulate what problem each are attempting to mitigate or solve.